

Assembly instructions

Charlton

Content:

Allen Screws 5/16"x2"	10 un.
Washer 5/16"	10 un.
Wood Feet	2 un.
Allen Key	1 un.

1 - For assembly, access the underside of the product. Ask for help from someone else to do the operation.

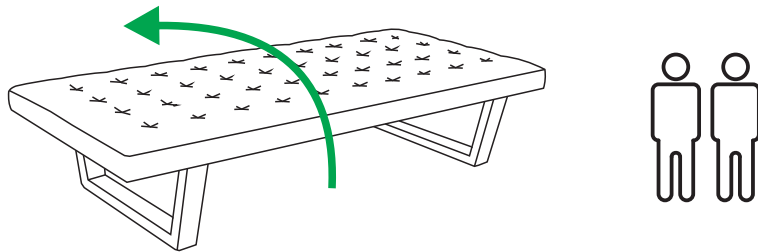

2 - Position the feet on the bottom part of the bench, adjusting the feet holes by the marked holes on the product.

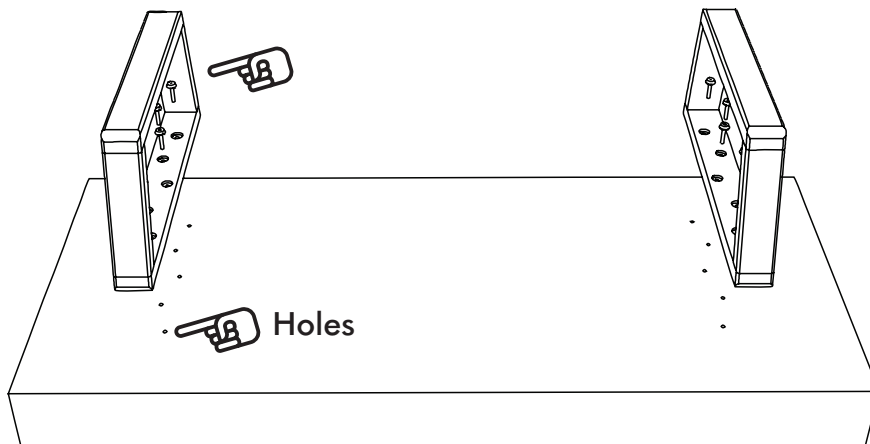

Back view

3- Use the Allen Screws and allen key 5/16" (included) to attach the feet . Position on the holes first the washers then the screws. Tighten clockwise.

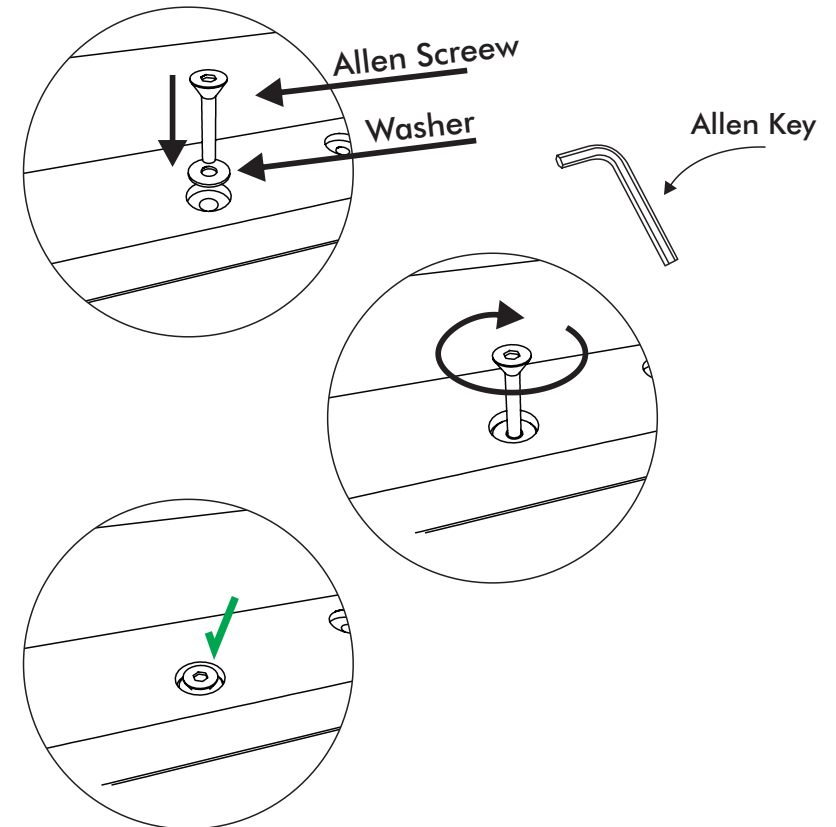

4 - Repeat in all screws on the both feet. Tighten them firmly.